

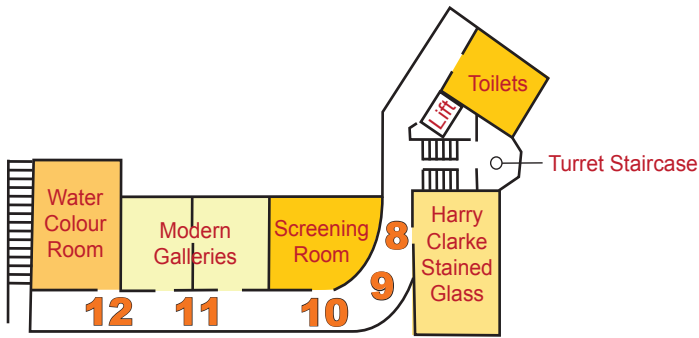

# Gallery Exhibition Map

www.crawfordartgallery.ie



## Second Floor

Please note this floor closes daily at 4:45pm

- 12** WATERCOLOUR ROOM  
*The Eye of the Artist*  
Ongoing
- 11** MODERN GALLERIES  
*Annie O'Ne - Canthus*  
Until 1 April 2017
- 10** VIDEO PROJECTION ROOM  
*Garrett Phelan - A VOODOO FREE PHENOMENONFILM*  
25 November 2016–18 March 2017

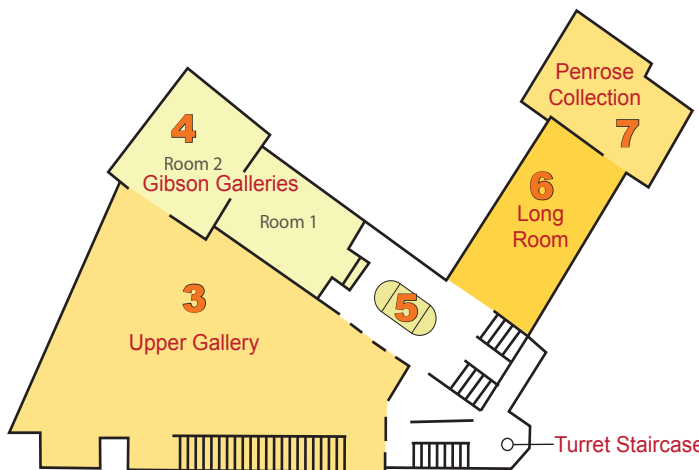

## First Floor

Please note this floor closes daily at 4:45pm

- 9** SECOND FLOOR CORRIDOR  
*Our Choice*  
Ongoing
- 8** HARRY CLARKE ROOM  
*A selection of Watercolours and Stained Glass*  
Ongoing
- 7** COOPER PENROSE ROOMS  
*Cooper Penrose Collection*  
Ongoing
- 6** LONG ROOM  
*Art & Patronage in Eighteenth Century Cork*  
Ongoing
- 5** GIBSON CENTRAL CABINET  
*Gibson Collection*  
Ongoing
- 4** GIBSON GALLERIES  
*Irish Art 1870–1970: Highlights from the Permanent Collection*  
Ongoing

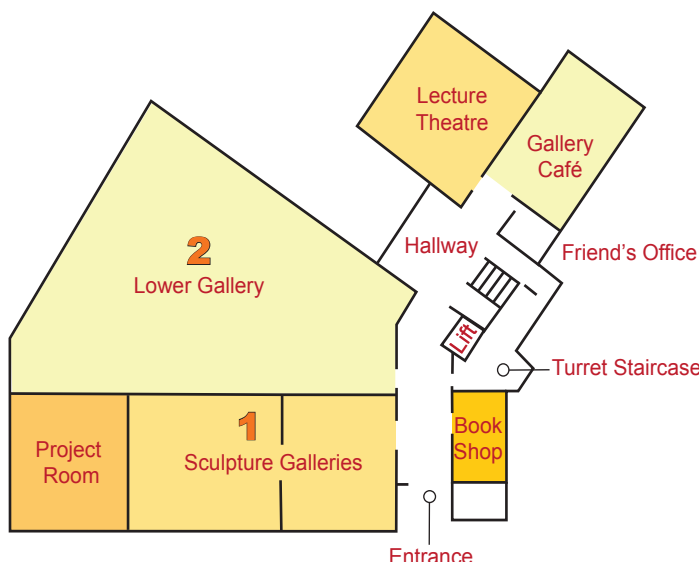

## Ground Floor

- 3** UPPER GALLERY  
*The Way Home - Mid 20th century Irish Works*  
Until 14 October 2017
- 2** LOWER GALLERY  
*Crawford at the Castle*  
11 March–10 June 2017
- SCULPTURE GALLERIES  
**1** *Classical and Neo-Classical Works, Canova Casts, John Hogan and Maud Cotter*