

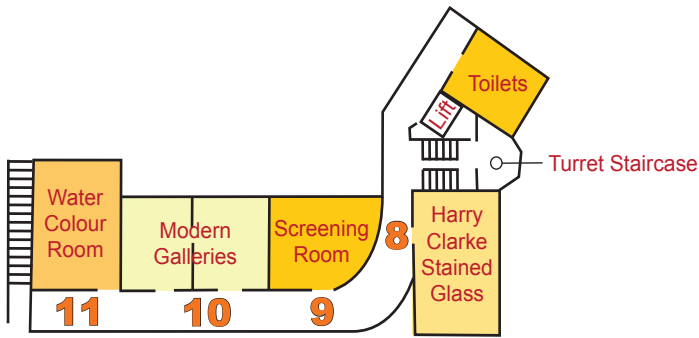

Gallery Exhibition Map



Second Floor

Please note this floor closes daily at 4:45pm

- 11** WATERCOLOUR ROOM
The Eye of the Artist
Ongoing
- 10** MODERN GALLERIES
Under the Goldie Fish - Views of Cork from the Collection
Ongoing

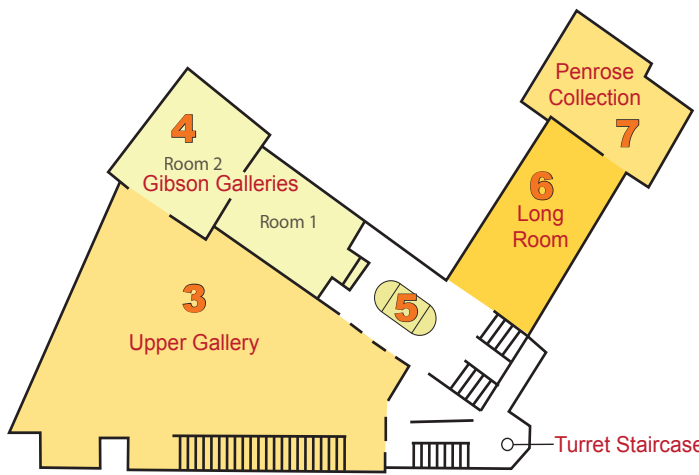

First Floor

Please note this floor closes daily at 4:45pm

- 9** SCREENING ROOM
Great Irish Journeys with Martha Kearney
Until 24 February 2018
- 8** HARRY CLARKE ROOM
A selection of Watercolours and Stained Glass
Ongoing
- 7** COOPER PENROSE ROOMS
Cooper Penrose Collection
Ongoing
- 6** LONG ROOM
Eighteenth Century Cork from the Permanent Collection
Until 20 January 2018
- 5** GIBSON CENTRAL CABINET
John ffrench Ceramics
Ongoing

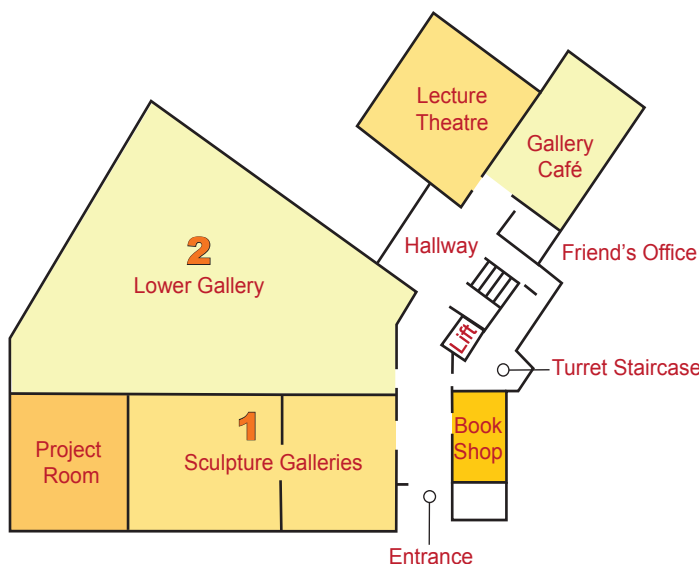

Ground Floor

- 4** GIBSON GALLERIES
Permanent Collection
Until 20 January 2018
- 3** UPPER GALLERY
MUSIC, MYTH AND MAGIC: A Winter Exhibition
Until 28 April 2018
- 2** LOWER GALLERY
Stones, Slabs and Seascapes: George Victor du Noyer's Images of Ireland
Until 24 February 2018
- 1** SCULPTURE GALLERIES
Classical and Neo-Classical Works, Canova Casts, John Hogan and Maud Cotter
Ongoing